



Unicla 200 SERIES COMPRESSORS

High capacity. Suitable for heavy duty systems



200cc capacity

Heavy duty clutch

Interchangeable rear cap

Horizontal or vertical O-ring hose ports

R134a service valves

High pressure relief valve

Oil return port

PAG or POE Oil

Features

The Unicla 200 Series compressors have been designed to meet the demands of larger capacity and twin air-conditioning systems fitted to vehicles in commercial and heavy duty working environments. Many vehicle air-conditioning systems in service today have compressors that are either too small or too large. The 200 series has solved this 'gap' in compressor sizing which makes it most suitable for mini bus, military vehicles, trucks and tractors.

The compressors feature the famous Unicla 10 cylinder swashplate design which produces an extremely quiet and smooth operation and delivers excellent performance through all rev ranges in either clockwise or counter-clockwise direction. The compressors are fitted with service valves, top and bottom oil plugs and a high pressure relief valve is available as an option. The outside crankcase is manufactured in one piece to reduce any chance of leaking, which is further enhanced with the special Unicla rear cap and front shaft lip seal.

Three distinct 200 series models are available:

- UP200** R134a refrigerant-Standard lug type
- UX200** R134a refrigerant-Direct bolt through type
- UPF200** R404a refrigerant-Standard lug type

Mounting

The UP200 is suited to mounting brackets made for compressors with 80 mm lug spacing. The layout and design of the mounting lugs make the UP200 easy to fit to most popular engines. The UX200 is the direct mount (bolt through) version of the UP200 and has side mounting points 94mm apart. Both are designed for operation with R134a, while the UPF200 is designed for R404a refrigerant and has upgraded internal components. POE oil and oil return port is fitted as standard.

Clutches

A diverse range of clutches is available in AA, B section and Polygroove, and 12 or 24 volt. The featured compressor here is the UP200- 4675 with AA groove, 12 volt clutch and vertical O-ring ports.

Hose Ports

A choice of O-ring ports are available in vertical or horizontal configuration.

Service Valves

Low and high side service valves are fitted as standard and can be easily removed if not required. The low side valve can be placed in two positions on the compressor.

Oil Return Port

A Unicla Oil Return Port is available for the UP200 as standard and easily unscrews from the top oil filler plug. It can also be interchanged with the low side service port. It is a standard male flare fitting and is suited to the Unicla Oil Separator part no. OS000010.

Unicla Compressor Groups

A Group – Smaller capacity models from 45cc to 170cc
C Group – Same as B Group fitted with protection sensor

B Group – Larger capacity models from 200cc to 600cc
D Group – OE and special applications



Unicla 200 SERIES COMPRESSORS

Technical Specifications

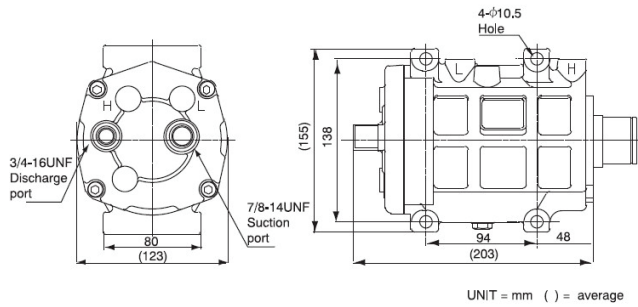

UX200 with horizontal O-ring ports (side and rear view)

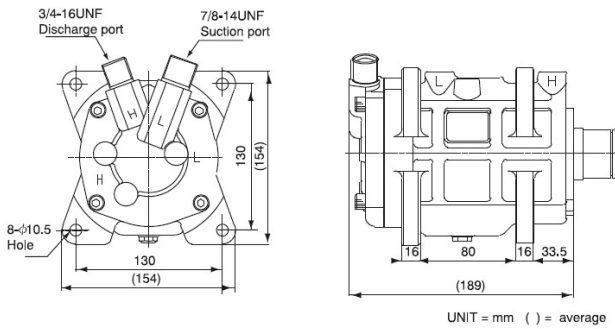

UP200 with vertical O-ring ports (side and rear view)

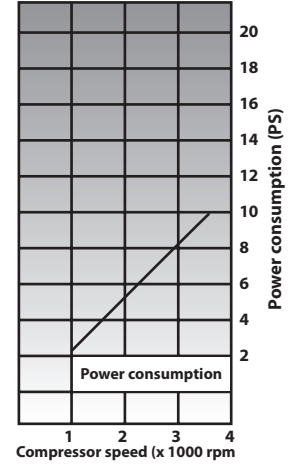
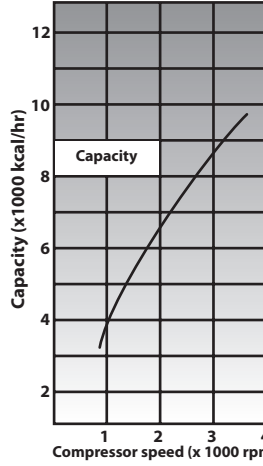

Operating Conditions	
Pressure suction	1.86kg.cm ² G
Pressure discharge	15.5kg/cm ² G
Super heat	10°C
Sub cooling	5°C

Specifications	
Model	UP/UX-200
Displacement	200cc/rev.
No. of cylinders	10
Max momentary speed	4500 rpm
Lubricant	Unidap 7 (PAG)
Initial oil charge	180cc

200 Series Performance data operating with R134a

Rear Caps and Hose Ports available for Unicla 200 Series Compressors

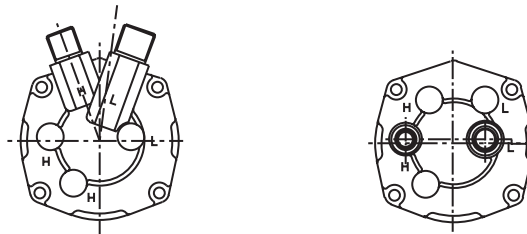

Vertical O-ring - U type 21503-000020 (O-ring)	Horizontal O-ring - DD type 21504-000020 (O-ring)
---	--

Clutches available for Unicla 200 Series Compressors

Type UP/UX200	Pulley Diameter (mm)				Voltage	
	125	135	145	152	12V	24V
AA Groove			•	•	•	•
B Groove			•		•	•
BB Groove			•	•	•	•
6 Groove	•				•	•
6 & 8 Groove		•			•	•

For detailed information about Unicla recommendations on such areas as fitting compressors in special applications, measuring compressor thermal and pressure loads, and calculating extra oil requirements in larger systems, we recommend you visit our website where expert advice from Unicla engineers can be found.



Unicla International Limited

Unit 1209-1210, 12F, Manhattan Centre, 8 Kwai Cheong Rd, Kwai Chung, N.T., Hong Kong. Phone (852) 2422 0180 Fax (852) 2422 0680 Email: sales@unicla.hk Website: www.unicla.hk

Distributed by: